

PUSH SIDE ELEVATION

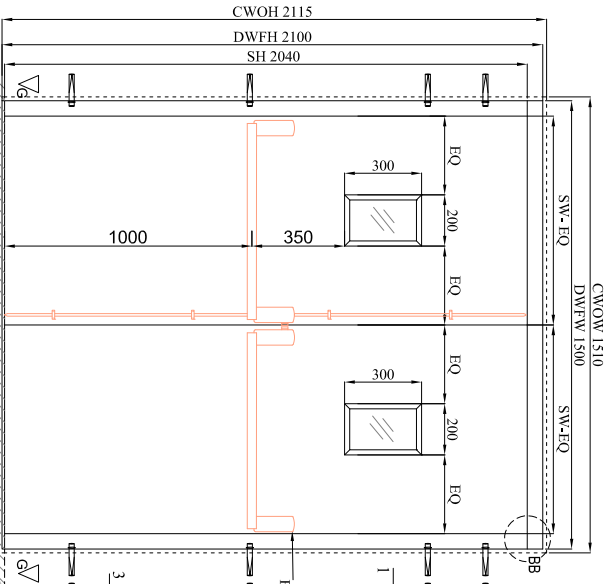

PULL SIDE ELEVATION

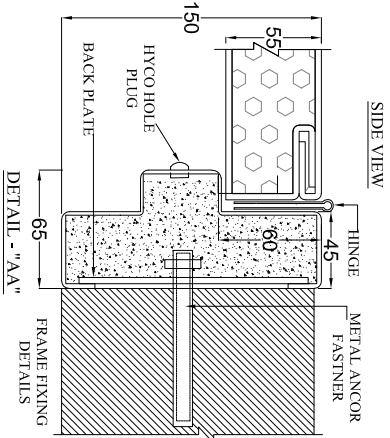
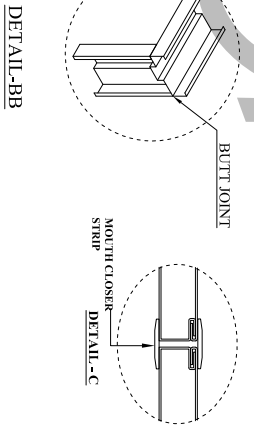
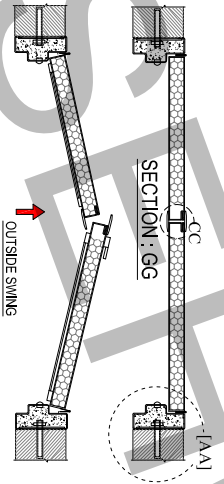
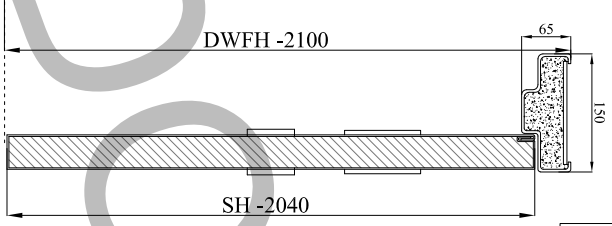
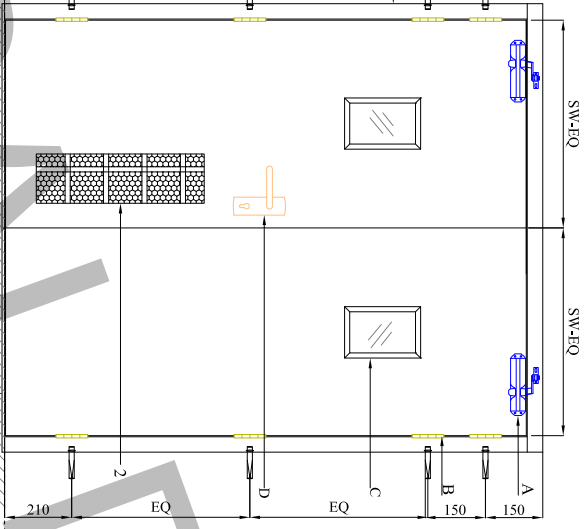

QTY. :-nos
 SIZE:- 1500X2100mm
2 Hrs. FIRE RATED

MATERIAL DETAIL:-	
DOOR FRAME SHEET THICK	1.6 MM G.I SHEET
STIFFNER SHEET THICK	1.2 MM G.I SHEET
SHUTTER SHEET THICK	1.2 MM G.I SHEET
INSULATION	CERAMIC
FINISH	POWDER COATED

PROFILE DETAIL	
1. DOOR FRAME	150mmX65mm
2. INTERNAL STRUCTURE OF DOOR SHUTTER	55mmTHICK
3. PROVISION FOR METAL ANCHOR FASTNER	09nos
4. TIE BAR	1

HARDWARE DETAIL:-			
S. NO.	NAME	BRAND	QTY
A	SURFACE MOUNTED DOOR CLOSER	DAUERHAFT	2
B	SS BALL BEARING HINGES(4"x3"x3mm)	DAUERHAFT	8
C	VISION PANEL 6mm THICK	WIRED	2
D	EXTERNAL TRIM	DAUERHAFT	1
E	3 POINT LATCH PANIC BAR	DAUERHAFT	1

- NOTE:-**
1. CWOH - CLEAR WALL OPENING WIDTH
 2. DWFH - DOOR WITH FRAME WIDTH
 3. SW - SHUTTER WIDTH
 4. CWOH - CLEAR WALL OPENING HEIGHT
 5. DWFH - DOOR WITH FRAME HEIGHT
 6. SH - SHUTTER HEIGHT
 7. ST - SHUTTER THICK.



PROJECT:-
 LOCATION:-
 CHECKED BY :- JITENDRA
 SIGNED :-
 APPROVED BY :- NEERAJ SEHGAL
 SIGNED :-
 APPROVAL BY CLIENT:-
 SIGNED :-

Drawn :- ARMAN Date :- 30-05-2020
 Title:- METAL FIRE DOOR
 1500X2100
 Scale NTS
 Units: Millimeter
 Dwg No. REV. Tolerance 4.5mm